



设计师: Sylvia Leydecker
设计公司: 100interiors
公司网址: www.100interior.de
项目地点: Munich, Germany

Sana Office

德国五大顶尖医疗保健医院之一的Sana执行总部搬到了慕尼黑的新处所，占地7000多平方米。这里的内部设计跟公司的设计很接近，表现在接待区和休息室。Sana世界的超大图像和典型的Sana蓝，以及枫木饰面，既给人亲切感又能提升公司品牌。三维立体墙面为钢制LOGO提供了低调的背景。

一方面，Sana的客户都是病人，组成了他们不同的目标群。另一方面，Sana的员工也是不均一的。他们唯一的共同点是都有人道主义精神，而这也是Sana的重心。这点体现在白色墙面上贴着的大量的“Care”、“Communicate”。整个建筑布满了小办公室，色彩打破了长廊的常规，从鲜艳的黄色到天蓝色再到银灰色，构成了一个鲜活的内部空间。排印是走廊和休息室唯一的颜色，除了接待处，其他的地方都是黑白地毯加上白色墙面。

The administrative headquarter of Sana, which is one of Germany's top 5 healthcare hospital groups, moved to a new location in Munich and now stretches over 7000 sqm. Their newly designed Corporate Interior is closely connected to the firm's Corporate Design, which shows at the reception and waiting lounge. Oversized images from Sana's world and overall-present typical Sana-blue is together with maple wood, also friendly and at the same time an efficient brand-booster. 3-dimensional wall-surface forms the understated background for the steel logo.

The clients of Sana are patients, who form their heterogeneous target group. On the other hand the staff is heterogenous as well. What they all do have in common is humanity, which is in Sana's focus. This is shown by numerous attributes such as "care" or "communicate" attached to the plain white walls. Throughout the building, which is dominated by cell office rooms, are typographic colour fields breaking the routine of the long aisles. Different colours, from bright yellow to sky-blue and silverfish grey, are forming a lively interior. Typography is the only colour-accent in the aisles and lounges, except the reception - everything else is anthracite and black carpet plus plain white walls.

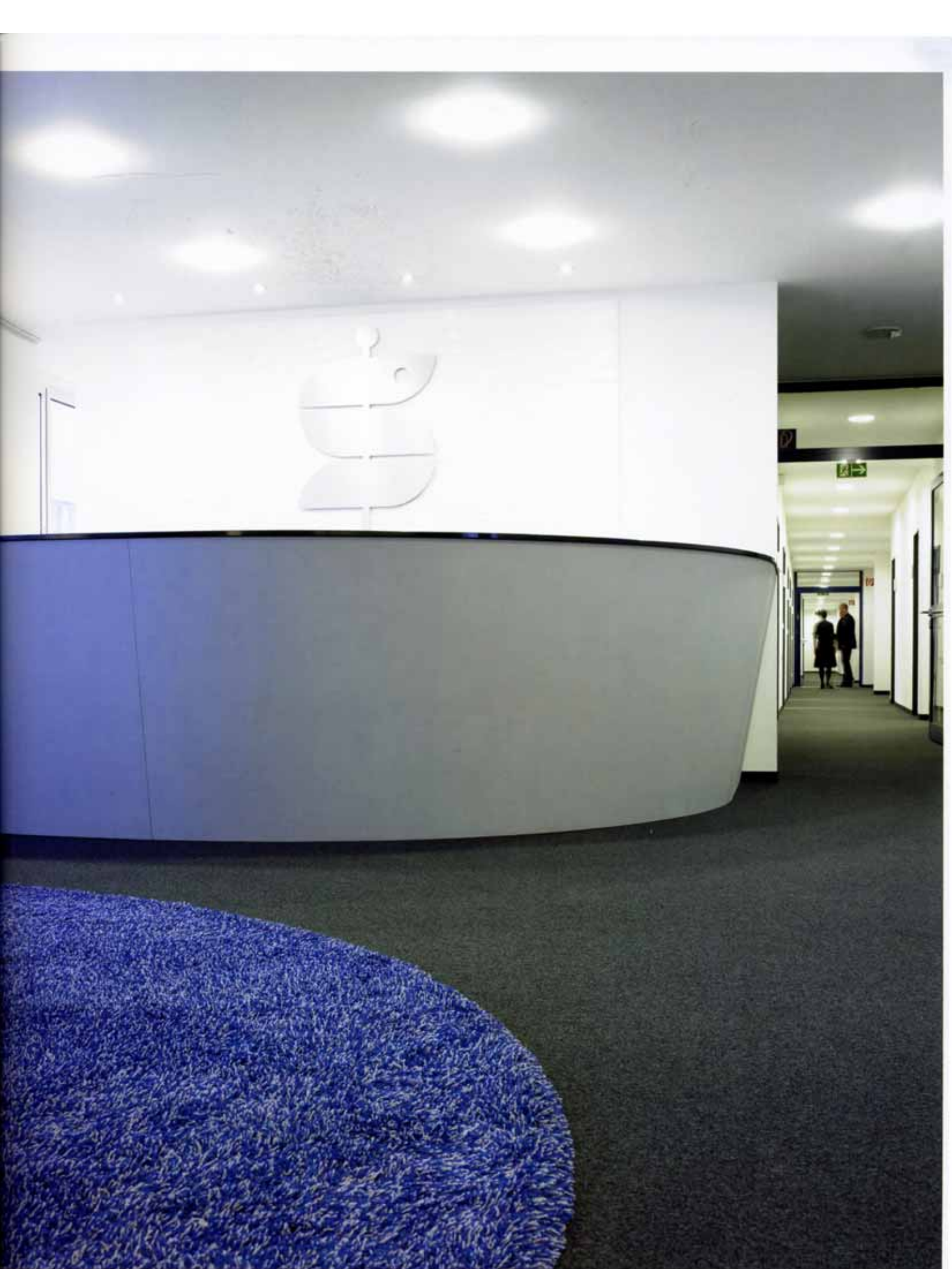



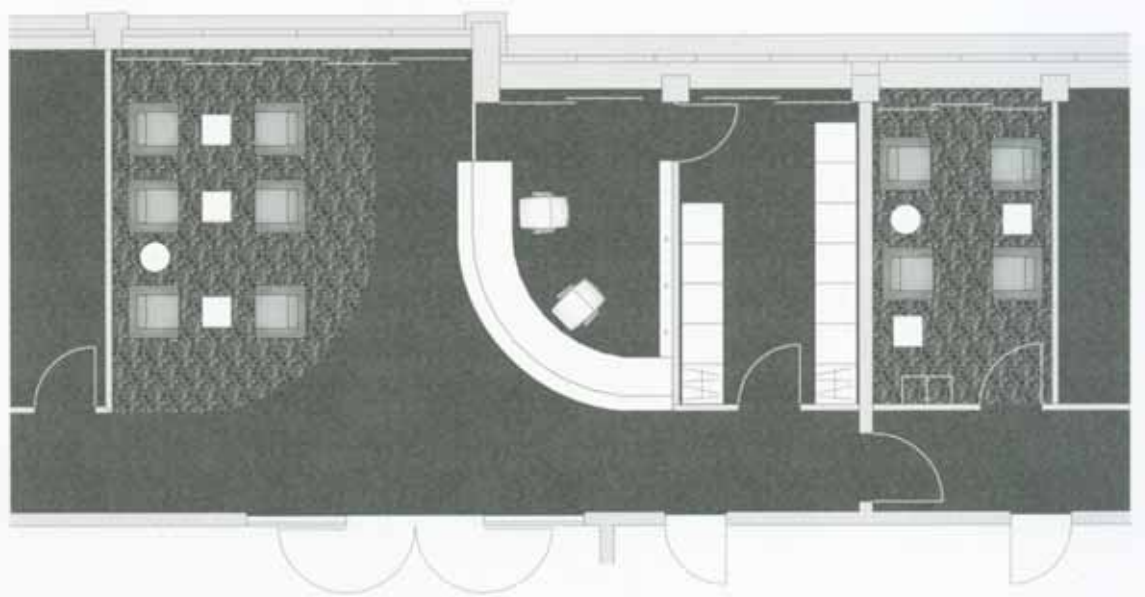





„you cannot not communicate“

(Paul Watzlawick)



红色则是Sana董事会的专属颜色。董事会的休息室给人以坚强有力的感觉，黑色红色的内部设计形成鲜明的对比。舒适的铺有地毯的地板与金属玻璃形成对比。永恒的包豪斯柯布西耶皮椅 LC3给公司的董事及来访者提供了舒适的座位。董事会的休息室、会议室以及所选的艺术品摆设都结合了格言“人们不能不沟通”，这也正是Sana的格言。员工可以在这样的一个休息室里放松：黑色松软的地毯，白色皮椅及鲜黄的墙面。

Red as a dominating colour is exclusively reserved for Sana's board. The board's lounge impresses with a strong and powerful, contrasting black and red interior design. Almost cosy carpet-flooring contrasts with metal and glass. Timeless Bauhaus Corbusier-leather-seats LC3 provide comfortable seating for the firm's board and their visitors.

The board's lounge and also the conference area integrate aphorisms "you cannot notcommunicate" which connect to Sana, as well as selected art pieces. Staff relaxes in a lounge with black fluffy carpet, combined with white leather seating and bright yellow walls.

